

BENDIX® AD-HF® & AD-HFi™ AIR DRYER APPLICATION GUIDE

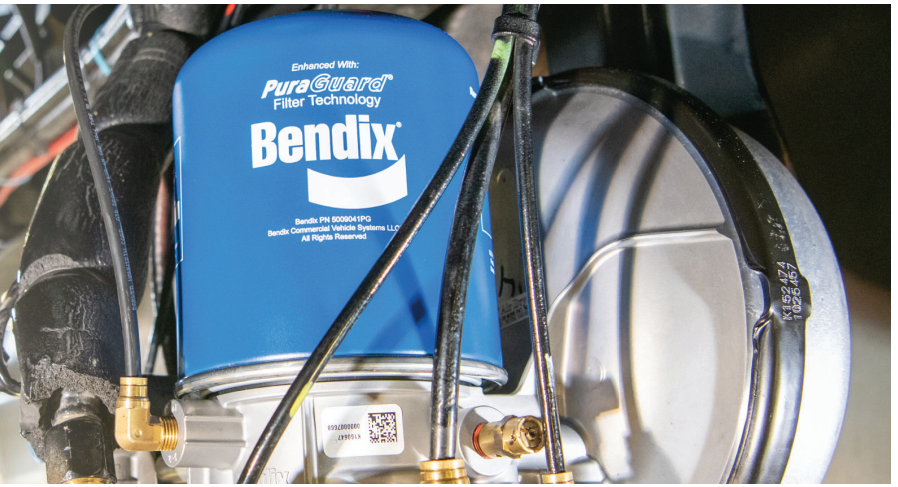

Designed with Fleets in Mind

Combining high-performance with long life, the Bendix® AD-HF® air dryer features a cast aluminum body that is rugged, durable, and provides significant protection from corrosion caused by harsh road treatments.

Our companion air dryer, the Bendix® AD-HFi™, offers the same features as the AD-HF but also utilizes an electronically controlled governor that enables increased dry air processing, is more energy-efficient, and provides for diagnostic capabilities.

Since these air dryers were designed with our customers in mind, servicing them is a snap. The serviceable parts between the two are nearly identical. The only difference is the AD-HFi uses a solenoid operated governor, whereas the AD-HF utilizes the mechanical Bendix® D2® governor. In addition, instead of replacing the entire air dryer, cartridge pressure protection valve kits, which are used for common service issues like dirt and corrosion failures, can be easily field installed in both the AD-HF and AD-HFi air dryer.



41 mm Oil Coalescing Cartridge



Cartridge Pressure Protection Valve Kit



Purge Valve Kit



D-2® Governor Kit



| Product | Part Number | Air Dryer Type | Service New/Reman | OEM | Description |
|--|-------------|----------------|-------------------|-----------|--|
| Aftermarket Air Dryer | K160647SC | AD-HF® | Service New | PACCAR | 12V DC, Standard Purge |
| | K160648SC | AD-HF | Service New | PACCAR | 12V DC, Extended Purge |
| | K160649SC | AD-HF | Service New | PACCAR | 24V DC, Extended Purge |
| | K160650SC | AD-HF | Service New | PACCAR | 12V DC, Standard Purge Extended Purge Port |
| | K162935SC | AD-HF | Service New | Isuzu | 12V, DC, Standard Purge |
| | K164016SC | AD-HF | Service New | Ford | 12V DC, Standard Purge |
| | K164017SC | AD-HF | Service New | Navistar® | 12V DC, Standard Purge |
| | K164018SC | AD-HF | Service New | Hino® | 12V DC, Standard Purge |
| | K164293SC | AD-HF | Service New | Navistar | 12V DC Standard Purge |
| | K183940SC | AD-HFi™ | Service New | PACCAR | Electronic Governor, Standard Purge |
| | K183941SC | AD-HFi | Service New | PACCAR | Electronic Governor, Extended Purge |
| <i>All service new AD-HF air dryers (SC suffix on the part number) have a core charge.</i> | | | | | |
| Cartridge Pressure Protection Valve (CPPV) Kits | K194713 | AD-HF | N/A | PACCAR | AD-HF CPPV Kit |
| | K194714 | AD-HF | N/A | Ford | AD-HF CPPV Kit |
| | K194715 | AD-HF | N/A | Hino | AD-HF CPPV Kit |
| | K194715 | AD-HF | N/A | Isuzu | AD-HF CPPV Kit |
| | K210935 | AD-HF | N/A | Navistar | AD-HF CPPV Kit |
| <i>CPPV kits are offered for every application. One kit contains four cartridges, mounting hardware, o-rings and lube. See chart A below for CPPV spring setting PSIs by corresponding cavity. See chart B below for the proper CPPV cavity locations.</i> | | | | | |

Chart A: Cartridge Pressure Protection Valve (CPPV) Spring Setting PSIs

| OEM | Kit Part Number | Port/Cavity Designation | | | |
|----------|-----------------|-------------------------|-----|-----|-----|
| | | 21 | 22 | 23 | 24 |
| PACCAR | K194713 | 103 | 112 | 112 | 112 |
| Ford | K194714 | 103 | 103 | 112 | 103 |
| Hino | K194715 | 112 | 103 | 112 | 103 |
| Isuzu | K194715 | 103 | 112 | 103 | 112 |
| Navistar | K210935 | 103 | 103 | 103 | 103 |

Chart B: Cavity Locations

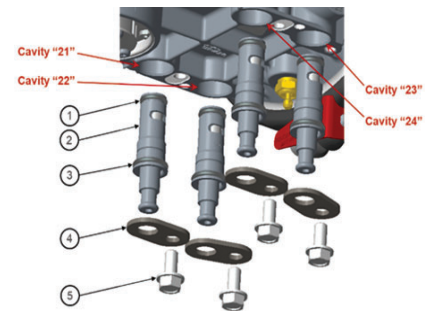

CPPVs are marked with their factory-set pressure setting.
The correct CPPV must be installed in its corresponding cavity.

| Product | Part Number | Air Dryer Type | Description |
|--|-------------|--|--|
| Governors | K194718 | AD-HF | Cut-in 105 PSI, Cut-out 130 PSI |
| | K194719 | AD-HF | Cut-in 105 PSI, Cut-out 125 PSI |
| | K194720 | AD-HF | Cut-in 120 PSI, Cut-out 140 PSI |
| | K232227 | AD-HF | Cut-in 128 PSI, Cut-out 139 PSI |
| | K207883 | AD-HFi | 12-Volt Solenoid-operated |
| Air Dryer Cartridges | 5009041PG | AD-HF, AD-HFi | PuraGuard® Oil Coalescing Cartridge (41mm Thread) |
| Purge Valve Kits | K022105 | AD-HF, AD-HFi, Bendix® AD-IS®, Bendix® AD-IP®, Bendix® AD-9si® | Air Dryer Hard Seat Purge Valve Kit |
| | K031562 | AD-HF, AD-HFi, AD-IS, AD-IP, AD-9si | Air Dryer DLU Purge Valve Kit |
| AD-HF / AD-HFi Major Maintenance Kits | K244456 | AD-HF, AD-HFi | Desiccant Cartridge & Purge Valve Kit |
| | K244460 | AD-HF, AD-HFi | Desiccant Cartridge, Purge Valve Kit & CPPV Kit #1 103, #3 112 |
| | K244463 | AD-HF, AD-HFi | Desiccant Cartridge, Purge Valve Kit & CPPV Kit #3 103, #1 112 |
| | K244465 | AD-HF, AD-HFi | Desiccant Cartridge, Purge Valve Kit & CPPV Kit #2 103, #2 112 |

The Bendix® AD-HF and AD-HFi air dryers are the highest performance air supply solution for commercial vehicles. For more information, contact your Bendix Account Manager, call 1-800-AIR-BRAKE or visit bendix.com or B2Bendix.com today.

